

Licensing Act 2003

**Premises Licence****LEIPRM0535**Leicester  
City CouncilLocal Services & Enforcement  
Leicester City Council  
Phoenix House  
1 King Street  
Leicester  
LE1 6RN(0116) 4543040  
[licensing@leicester.gov.uk](mailto:licensing@leicester.gov.uk)

## Part 1 - Premises Details

## POSTAL ADDRESS OF PREMISES, OR IF NONE, ORDNANCE SURVEY MAP REFERENCE OR DESCRIPTION

**Lost Bar**

139 Narborough Road, Leicester, LE3 0PB.

Telephone 0116 2856500

## WHERE THE LICENCE IS TIME LIMITED THE DATES

Not applicable

Expires **no expiry**

## LICENSABLE ACTIVITIES AUTHORISED BY THE LICENCE

- an indoor sporting event
- a performance of live music
- any playing of recorded music
- a performance of dance
- entertainment of a similar description to that falling within a performance of live music, any playing of recorded music or a performance of dance
- provision of late night refreshment
- the supply of alcohol

## THE TIMES THE LICENCE AUTHORISES THE CARRYING OUT OF LICENSABLE ACTIVITIES

Activity (and Area if applicable)	Description	Time From	Time To
C. Indoor sporting event	Mon-Thur	10:00am	Midnight
	Fri-Sat	10:00am	1:00am
	Sunday	10:00am	11:00pm
E. Performance of live music (Indoors)	Mon-Sat	10:00am	Midnight
	Sunday	10:00am	11:00pm
F. Playing of recorded music (Indoors)	Mon-Thur	10:00am	Midnight
	Fri-Sat	10:00am	1:00am
	Sunday	10:00am	11:00pm
G. Performance of dance (Indoors)	Mon-Thur	10:00am	Midnight
	Fri-Sat	10:00am	1:00am
	Sunday	10:00am	11:00pm
H. Entertainment of a similar description to that falling within E, F, or G (Indoors)	Mon-Thur	10:00am	Midnight
	Fri-Sat	10:00am	1:00am
	Sunday	10:00am	11:00pm





Licensing Act 2003  
**Premises Licence**

**LEIPRM0535**



Leicester  
City Council

Local Services & Enforcement  
Leicester City Council  
Phoenix House  
1 King Street  
Leicester  
LE1 6RN

(0116) 4543040  
[licensing@leicester.gov.uk](mailto:licensing@leicester.gov.uk)

**THE TIMES THE LICENCE AUTHORISES THE CARRYING OUT OF LICENSABLE ACTIVITIES continued ...**

Activity (and Area if applicable)	Description	Time From	Time To
I. Late night refreshment (Indoors)	Mon-Thur	11:00pm	Midnight
	Fri-Sat	11:00pm	1:00am
J. Supply of alcohol for consumption ON and OFF the premises	Mon-Thur	10:00am	Midnight
	Fri-Sat	10:00am	1:00am
	Sunday	10:00am	11:00pm

**THE OPENING HOURS OF THE PREMISES**

Description	Time From	Time To
Mon-Thur	10:00am	12:30am
Fri-Sat	10:00am	1:30am
Sunday	10:00am	11:30pm

**WHERE THE LICENCE AUTHORISES SUPPLIES OF ALCOHOL WHETHER THESE ARE ON AND / OR OFF SUPPLIES**

- J. Supply of alcohol for consumption ON and OFF the premises

**Part 2**

**NAME, (REGISTERED) ADDRESS, TELEPHONE NUMBER AND EMAIL (WHERE RELEVANT) OF HOLDER OF PREMISES LICENCE**

Julius Ephi

1 Portland Road, Leicester, LE2 3AB.

**REGISTERED NUMBER OF HOLDER, FOR EXAMPLE COMPANY NUMBER, CHARITY NUMBER (WHERE APPLICABLE)**

**NAME, ADDRESS AND TELEPHONE NUMBER OF DESIGNATED PREMISES SUPERVISOR WHERE THE PREMISES LICENCE AUTHORISES THE SUPPLY OF ALCOHOL**

Julius EPHI

**PERSONAL LICENCE NUMBER AND ISSUING AUTHORITY OF PERSONAL LICENCE HELD BY DESIGNATED PREMISES SUPERVISOR WHERE THE PREMISES LICENCE AUTHORISES FOR THE SUPPLY OF ALCOHOL**

Licence No. BLP0804

Issued by Blaby





## Premises Licence



Leicester  
City Council

Local Services & Enforcement  
Leicester City Council  
Phoenix House  
1 King Street  
Leicester  
LE1 6RN

(0116) 4543040  
[licensing@leicester.gov.uk](mailto:licensing@leicester.gov.uk)

## ANNEXES

## Annex 1 - Mandatory conditions

No supply of alcohol may be made under the premises licence -

- a) at a time when there is no designated premises supervisor in respect of the premises licence, or
- b) at a time when the designated premises supervisor does not hold a personal licence or his personal licence is suspended.

Every supply of alcohol under the premises licence must be made or authorised by a person who holds a personal licence.

The responsible person must ensure that staff on relevant premises do not carry out, arrange or participate in any irresponsible promotions in relation to the premises. In this paragraph, an irresponsible promotion means any one or more of the following activities, or substantially similar activities, carried on for the purpose of encouraging the sale or supply of alcohol for consumption on the premises-

- a) games or other activities which require or encourage, or are designed to require or encourage, individuals to-
  - i) drink a quantity of alcohol within a time limit (other than to drink alcohol sold or supplied on the premises before the cessation of the period in which the responsible person is authorised to sell or supplied alcohol), or
  - ii) drink as much alcohol as possible (whether within a time limit or otherwise);
- b) provision of unlimited or unspecified quantities of alcohol free or for a fixed or discounted fee to the public or to a group defined by a particular characteristic in a manner which carries a significant risk of undermining a licensing objective;
- c) provision of free or discounted alcohol or any other thing as a prize to encourage or reward the purchase and consumption of alcohol over a period of 24 hours or less in a manner which carries a significant risk of undermining a licensing objective;
- d) selling or supplying alcohol in association with promotional posters or flyers on, or in the vicinity of, the premises which can reasonably be considered to condone, encourage or glamorise anti-social behaviour or to refer to the effects of drunkenness in any favourable manner;
- e) dispensing alcohol directly by one person into the mouth of another (other than where that other person is unable to drink without assistance by reason of a disability).

The responsible person must ensure that free potable water is provided on request to customers where it is reasonably available.

The premises licence holder or club premises certificate holder must ensure that an age verification policy is adopted in respect of the premises in relation to the sale or supply of alcohol.

The designated premises supervisor in relation to the premises licence must ensure that the supply of alcohol at the premises is carried on in accordance with the age verification policy.

The policy must require individuals who appear to the responsible person to be under 18 years of age (or such older age as may be specified in the policy) to produce on request, before being served alcohol, identification bearing their photograph, date of birth and either-

- a) a holographic mark, or
- b) an ultraviolet feature.

The responsible person shall ensure that-

- a) where any of the following alcoholic drinks is sold or supplied for consumption on the premises (other than alcoholic drinks sold or supplied having been made up in advance ready for sale or supply in a securely closed container) it is available to customers in the following measures-
  - i) beer or cider: ½ pint;
  - ii) gin, rum, vodka or whisky: 25 ml or 35 ml; and
  - iii) still wine in a glass: 125 ml;
- b) these measures are displayed in a menu, price list or other printed material which is available to customers on the premises; and
- c) where a customer does not in relation to a sale of alcohol specify the quantity of alcohol to be sold, the customer is made aware that these measures are available.

A relevant person shall ensure that no alcohol is sold or supplied for consumption on or off the premises for a price which is less than the permitted price.

## Annex 2 - Conditions consistent with the operating schedule

The restrictions in this Annex do not prohibit any sale, supply or consumption of alcohol previously permitted by the Licensing Act 1964.

Alcohol shall not be sold or supplied unless it is paid for before or at the time when it is sold or supplied, except alcohol sold or supplied with and for consumption at a meal supplied at the same time, consumed with the meal and paid for together with the meal.





Licensing Act 2003

# Premises Licence

# LEIPRM0535



Leicester  
City Council

Local Services & Enforcement  
Leicester City Council  
Phoenix House  
1 King Street  
Leicester  
LE1 6RN

(0116) 4543040  
[licensing@leicester.gov.uk](mailto:licensing@leicester.gov.uk)

## ANNEXES continued ...

Licensable activities may continue between the end of the hours permitted by the licence on New Years Eve and the start of the hours permitted by the licence on New Years Day.

No person under fourteen shall be in the bar of the licensed premises during the hours that the premises is licensed for the sale of alcohol, except as previously permitted by the Licensing Act 1964.

Prominent, clear notices shall be displayed at all exits requesting customers to respect the needs of local residents and leave the premises and the area quietly.

During World Cup finals matches in cricket, rugby and football the following licensable activities will be extended from one hour before commencement of the match until one hour after it finishes:

Entertainment of a similar description to Performance of Live Music, Playing of Recorded Music and Performance of Dance; Provision of facilities for entertainment of a similar description that falling within Provision of Facilities for Making music or Provision of Facilities for Dancing; Late Night Refreshment; Sale by Retail of Alcohol; Opening Hours.

### Annex 3 - Conditions attached after a hearing by the Licensing Authority

The licensee will ensure that CCTV is installed following advice from the Leicestershire Constabulary and maintained in accordance with the Information Commissioner's CCTV Code of Practice.

The Challenge 21 policy will be adopted and there will be adequate, documented training for staff (paid or unpaid) before they are allowed to serve alcohol. Detailed records of what this training comprises of will be kept and evidence of the training carried out. This training will be repeated every three months, in order to retain focus, and records of that training will be provided to Council licensing officers and police on request.

An incident and refusals register will be maintained at the premises and made available to the Police and Licensing Authority on request.



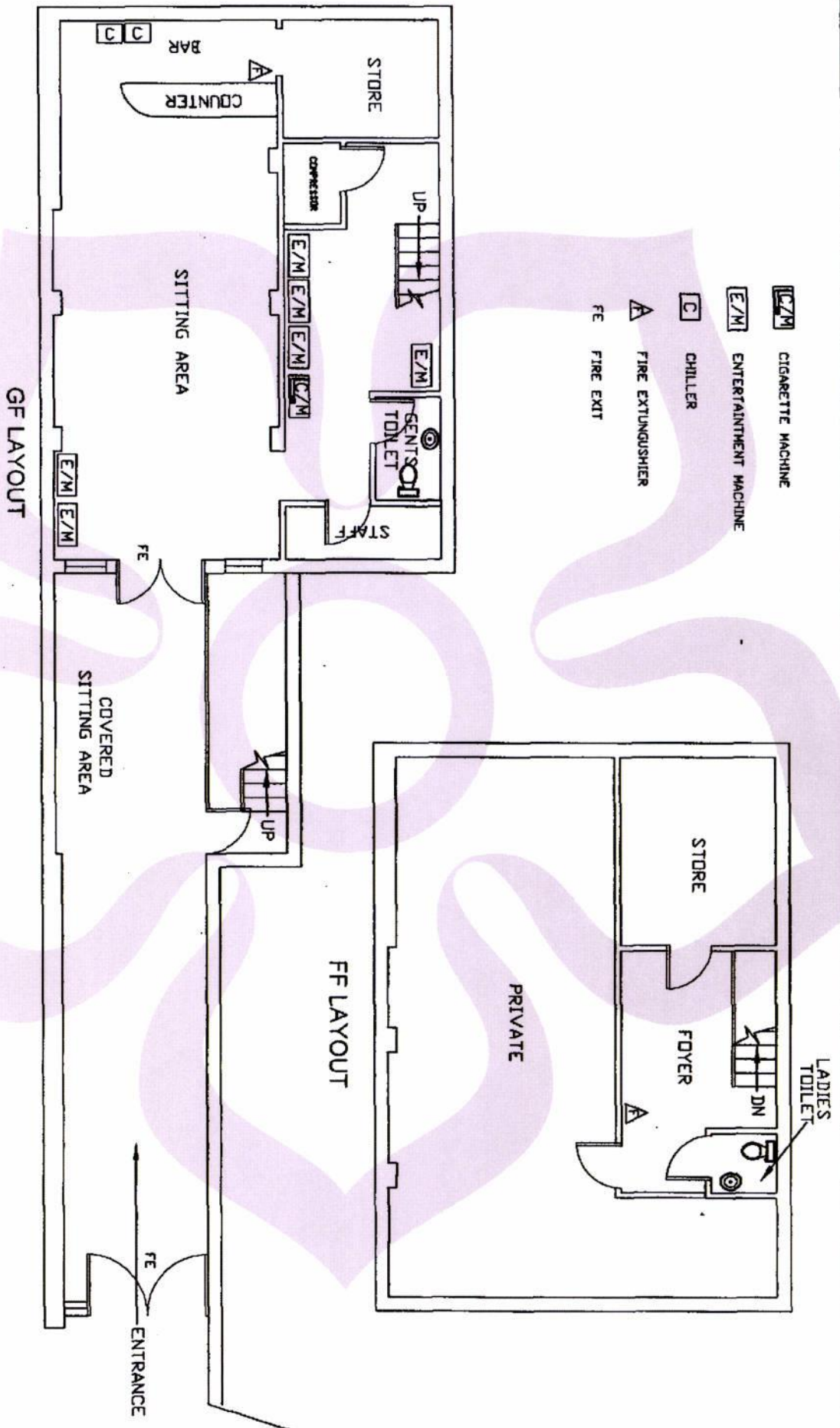

**D T DESIGNS LIMITED**  
 74 WYVERN AVENUE  
 LEICESTER LE4 7JH  
 TEL: (0116) 266847  
 FAX: (0116) 260840  
 MOBILE: (07770) 246401  
 Email: dt.planning@btworld.com

**DRAWING NO.**  
 05/07/140

**LAYOUT FOR THE LOST BAR**  
 AT 139 NARBOROUGH ROAD  
 LEICESTER LE3 0PD  
 FOR MR D ALLEN

**SS**

**DATE**  
 29/07/05

**SCALE**  
 1:100



## Premises Licence Summary



Leicester  
City Council

Local Services & Enforcement  
Leicester City Council  
Phoenix House  
1 King Street  
Leicester  
LE1 6RN

(0116) 4543040  
[licensing@leicester.gov.uk](mailto:licensing@leicester.gov.uk)

## Premises Details

## POSTAL ADDRESS OF PREMISES, OR IF NONE, ORDNANCE SURVEY MAP REFERENCE OR DESCRIPTION

**Lost Bar**

139 Narborough Road, Leicester, LE3 0PB.

Telephone 0116 2856500

## WHERE THE LICENCE IS TIME LIMITED THE DATES

Not applicable

## LICENSABLE ACTIVITIES AUTHORISED BY THE LICENCE

- an indoor sporting event
- a performance of live music
- any playing of recorded music
- a performance of dance
- entertainment of a similar description to that falling within a performance of live music, any playing of recorded music or a performance of dance
- provision of late night refreshment
- the supply of alcohol

## THE TIMES THE LICENCE AUTHORIZES THE CARRYING OUT OF LICENSABLE ACTIVITIES

Activity (and Area if applicable)	Description	Time From	Time To
C. Indoor sporting event	Mon-Thur	10:00am	Midnight
	Fri-Sat	10:00am	1:00am
	Sunday	10:00am	11:00pm
E. Performance of live music (Indoors)	Mon-Sat	10:00am	Midnight
	Sunday	10:00am	11:00pm
F. Playing of recorded music (Indoors)	Mon-Thur	10:00am	Midnight
	Fri-Sat	10:00am	1:00am
	Sunday	10:00am	11:00pm
G. Performance of dance (Indoors)	Mon-Thur	10:00am	Midnight
	Fri-Sat	10:00am	1:00am
	Sunday	10:00am	11:00pm
H. Entertainment of a similar description to that falling within E, F, or G (Indoors)	Mon-Thur	10:00am	Midnight
	Fri-Sat	10:00am	1:00am
	Sunday	10:00am	11:00pm







Leicester  
City Council

Local Services & Enforcement  
Leicester City Council  
Phoenix House  
1 King Street  
Leicester  
LE1 6RN

(0116) 4543040  
[licensing@leicester.gov.uk](mailto:licensing@leicester.gov.uk)

**THE TIMES THE LICENCE AUTHORISES THE CARRYING OUT OF LICENSABLE ACTIVITIES continued ...**

Activity (and Area if applicable)	Description	Time From	Time To
I. Late night refreshment (Indoors)	Mon-Thur	11:00pm	Midnight
	Fri-Sat	11:00pm	1:00am
J. Supply of alcohol for consumption ON and OFF the premises	Mon-Thur	10:00am	Midnight
	Fri-Sat	10:00am	1:00am
	Sunday	10:00am	11:00pm

**THE OPENING HOURS OF THE PREMISES**

Description	Time From	Time To
Mon-Thur	10:00am	12:30am
Fri-Sat	10:00am	1:30am
Sunday	10:00am	11:30pm

**WHERE THE LICENCE AUTHORISES SUPPLIES OF ALCOHOL WHETHER THESE ARE ON AND / OR OFF SUPPLIES**

- J. Supply of alcohol for consumption ON and OFF the premises

**NAME, (REGISTERED) ADDRESS OF HOLDER OF PREMISES LICENCE**

Julius Ephi

1 Portland Road, Leicester, LE2 3AB.

**REGISTERED NUMBER OF HOLDER, FOR EXAMPLE COMPANY NUMBER, CHARITY NUMBER (WHERE APPLICABLE)**
**NAME OF DESIGNATED PREMISES SUPERVISOR WHERE THE PREMISES LICENCE AUTHORISES THE SUPPLY OF ALCOHOL**

Julius EPHI

**STATE WHETHER ACCESS TO THE PREMISES BY CHILDREN IS RESTRICTED OR PROHIBITED**

Restricted

